

JF-800/720/700/20/930 双金属翻边轴承 Metric Standard Bushing

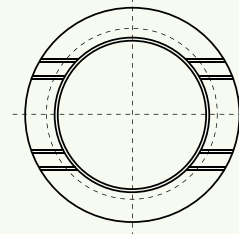
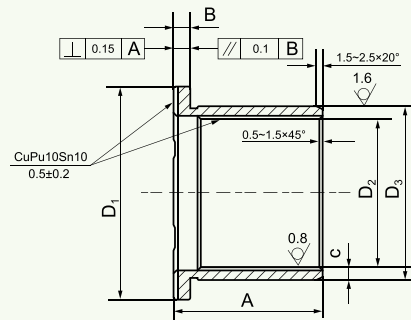

D ₁	B	D ₃	D ₂	A	C
42	3.5	37	30	30	3.5
43	2	34	30	28	2
44	3.5	39	32	35	3.5
47	3.5	39	32	50	3.5
48	2	39	35	37	2
52	3	41	35	35	3
55	3.5	42	35	35	3.5
55	3.5	45	38	35	3.5
55	3.5	45	38	40	3.5
60	3	41	35	42	3
60	3	46	40	62	3
63	3.5	47	40	40	3.5
65	3.5	52	45	40	3.5
68	3.5	54	47	35	3.5
70	3.5	54	47	40	3.5
70	3.5	57	50	48	3.5
72	3.5	57	50	45	3.5
72	3.5	57	50	50	3.5
75	3.5	57	50	50	3.5
77	3	60	54	55	3
83	3.5	66	59	53	3.5
85	3.5	65	58	60	3.5
87	3.5	67	60	53	3.5
87	3.5	67	60	60	3.5

D ₁	B	D ₃	D ₂	A	C
87	3.5	67	60	65	3.5
87	4	68	60	60	4
94	3.5	72	65	60	3.5
87	3.5	72	65	65	3.5
87.5	1.95	69.12	65.22	64.5	2
88	3.5	67	60	60	3.5
88	3.5	72	65	65	3.5
92	3.5	77	70	67	3.5
93	3.5	75	68	60	3.5
94	3.5	77	70	70	3.5
95	3.5	77	70	65	3.5
95	4	78	70	70	4
97	3.48	77.14	70.18	62	3.5
97	3.5	82	75	74	3.5
100	5	85	75	70	5
103	3.525	70.8	63.75	73	3.5
105	3.5	82	75	75	3.5
105	3.5	87	80	70	3.5
107	4	83	75	74	4
115	5	100	90	75	5
128	3.8	92.6	85	103	4
108	3.5	72	65	75	3.5
108	3.5	77	70	98	3.5
108	5	80	70	90	5

以上规格外径推荐公差 (+0.12 ~ +0.16)，配合轮体内孔 (+0.03 ~ +0.05)；
内孔推荐公差 (+0.20 ~ +0.25)，配合轴 (-0.14 ~ -0.16)。

□ 基材特性 Material Features

该产品以优质低碳钢为基体，表面烧结锡青铜合金，经多次烧结轧制而成，具有很高的疲劳强度和承载能力，高的抗冲击力。经过技术人员的进一步优化工艺，广泛应用到工程机械底盘四轮，空调压缩机等部位。特别在挖掘机四轮部位已广泛替代离心浇铸式双金属轴套，改善了原工艺材料不稳定，合金层偏心，材料浪费严重等缺点，在满足客户性能要求的前提下，进一步提高性价比，降低采购成本。

It is made of high quality low-carbon steel, and sintered and rolled copper alloy as its surface. It has high fatigue strength, load capacity and impact strength. The product is applies to con-rod of automobile engines, transmission gearbox, engineering and agriculture machinery, etc.