

JDB 铜基镶嵌式固体润滑轴承 Cast Bronze Solid-lubricant inlaid bearing

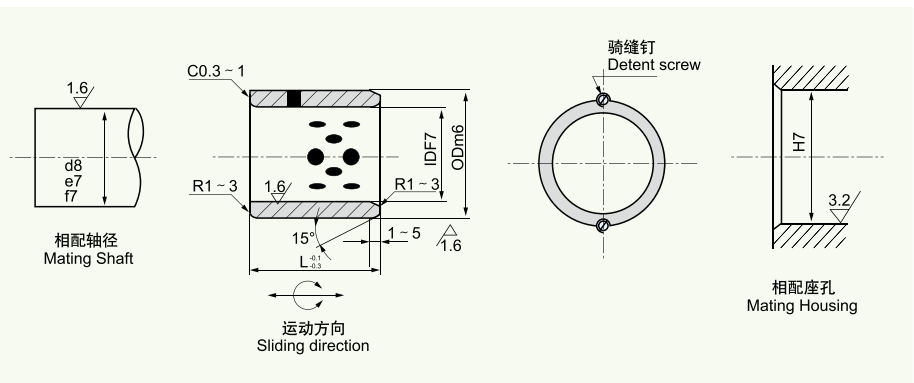

※标准产品标注方式：Standard Bushing Label Mode JDB □ 081208

单位Unit: mm

d	D	ID F7	OD m6	L ^{-0.10} / _{-0.30}												
				8	10	15	20	25	30	35	40	50	60			
8	12	8	12	081208	081210	081215										
10	14	10	14	101408	101410	101415	101420									
12	18	12	18		121810	121815	121820	121825								
13	19	13	19		131910	131915	131920									
14	20	14	20		142010	142015	142020	142025								
15	21	15	21		152110	152115	152120	152125								
16	22	16	22		162210	162215	162220	162225								
18	24	18	24			182415	182420	182425	182430							
20	28	20	28			202815	202820	202825	202830							
20	30	20	30				203020	203025	203030	203035						
22	32	22	32				223215	223220	223225	223230						
25	33	25	33				253315	253320	253325	253330	253335					
25	35	25	35				253515	253520	253525	253530	253535					
28	38	28	38				283820	283825	283830	283835						
30	38	30	38				303820	303825	303830	303835	303840					
30	40	30	40				304020	304025	304030	304035	304040					
32	42	32	42						324230	324235	324240					
35	45	35	45						354530	354535	354540	354550				
38	48	38	48						384830	384835	384840	384850				
40	50	40	50						405030	405035	405040	405050	405060			

JDB 铜基镶嵌式固体润滑轴承 Cast Bronze Solid-lubricant inlaid bearing



d	D	ID F7		OD m6		L ^{-0.10} / _{-0.30}									
						30	35	40	50	60	70	80	100		
40	55	40	+0.050 +0.025	55	+0.030 +0.011	405530	405535	405540	405550	405560					
45	60	45		60			456035	456040	456050	456060					
50	60	50		60				506035	506040	506050	506060	506070			
50	62	50		62					506235	506240	506250	506260	506270		
50	65	50		65						506540	506550	506560	506570		
55	70	55	+0.060 +0.030	70	+0.035 +0.013			557040	557050	557060	557070				
60	74	60		74					607440	607450	607460	607470			
60	75	60		75						607540	607550	607560	607570		
63	75	63		75							637550	637560	637570		
65	80	65		80							658050	658060	658070	658080	
70	85	70		85							708550	708560	708570	708580	
70	90	70		90							709050	709060	709070	709080	
75	90	75		90								759060	759070	759080	
80	96	80		96							809650	809660	809670	809680	
80	100	80		100							8010050	8010060	8010070	8010080	
100	120	100	+0.071 +0.036	120	+0.040 +0.015					10012060	10012070	10012080	100120100		
110	130	110		130									11013070	11013080	110130100
120	140	120		140									12014070	12014080	120140100
125	145	125		145										12514580	125145100
130	150	130		150										13015080	130150100
140	160	140		+0.083 +0.043		160								14016080	140160100
150	170	150				170								15017080	150170100
160	180	160				180								16018080	160180100

※推荐座孔公差H7，轴径公差d8(高承载)、e7(低承载)、f7(高精度)

Note: recommended tolerance of the housing is H7 and the diameter tolerance of the shaft is d8 (High Load).
e7 (Low Load) or f7 (High Precision)

JFB 铜基翻边镶嵌式固体润滑轴承 Cast Bronze Flanged Solid-lubricant inlaid bearing

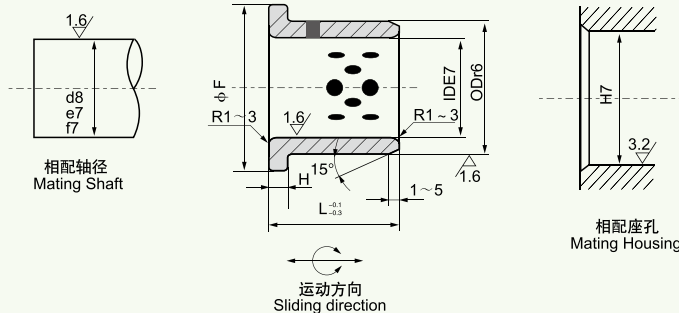

※标准产品标注方式：Standard Bushing Label Mode JDB □ 1015

单位Unit: mm

ID F7	OD r6	F	H _{-0.10} ⁰	L _{-0.30} ^{-0.10}												
				15	20	25	30	35	40	50	60	80	100			
10	+0.040 +0.025	14	22	2	1015	1020										
12		18	25	3	1215	1220										
13		19	26		1315	1320										
14	+0.050 +0.032	20	27		1415	1420										
15		21	28		1515	1520	1525	1530								
16		22	29		1615	1620	1625	1630								
20		30	40	5		2020	2025	2030	2035							
25	+0.061 +0.040	35	45			2520	2525	2530	2535							
30		40	50			3020	3025	3030	3035	3040	3050					
35		45	60				3525	3530	3535	3540	3550					
40		50	65					4030	4035	4040	4050					
45	+0.075 +0.050	55	70					4530	4535	4540	4550	4560				
50		60	75							5050	5050	5060				
55		65	80							5540	5550	5560				
60		75	90							6040	6050	6060	6080			
70	+0.090 +0.060	85	105		7.5						7050	7060	7080			
75		90	110							7550	7560					
80		100	120	10								8060	8080	80100		
100		120	150										10060	10080	100100	
120	+0.107 +0.072	140	170										12060	12080	120100	

※推荐座孔公差H7，轴径公差d8(高承载)、e7(低承载)、f7(高精度)

Note: recommended tolerance of the housing is H7 and the diameter tolerance of the shaft is d8 (High Load), e7 (Low Load) or f7 (High Precision)

JTW 止推垫片 Oilless Thrust Washers

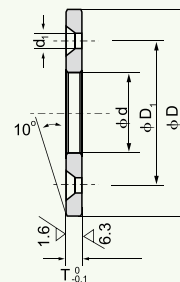
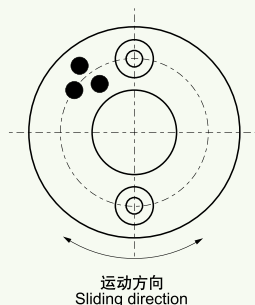

※标准产品标注方式: Standard Bushing Label Mode JFB □ 10

单位Unit: mm

型号规格 Designation	φ d	φ D	T _{-0.10} ⁰	螺孔 Bolt Hole											
				φ D ₁	平头螺钉 Crop Bolt	孔数 Bore Number	φ d ₁								
JTW 10	10.2	30	3	20	M3	2	3.5								
JTW 12	12.2	40		28	M3	2	3.5								
JTW 13	13.2														
JTW 14	14.2														
JTW 15	15.2	50		35	M3	2	3.5								
JTW 16	16.2														
JTW 16A			-					-	-	-					
JTW 18	18.2		35					M3	2	3.5					
JTW 20	20.2	M5		2	6.0										
JTW 20A			-			-	-	-							
JTW 25	25.2	55	5	40	M5	2	6								
JTW 25A								-	-	-	-				
JTW 30	30.2	60	7	45	M5	2	6								
JTW 35	35.2	70						50	M5	2	6				
JTW 40	40.2	80	7	60	M6	2	7								
JTW 45	45.3	90						67.5	M6	2	7				
JTW 50	50.3	100	8	75	M6	4	7								
JTW 55	55.3	110						85	M6	4	7				
JTW 60	60.3	120										90	M8	4	9
JTW 70	70.3	130	10	100	M8	4	9								
JTW 75	75.3	140						110	M8	4	9				
JTW 80	80.3	150										120	M8	4	9
JTW 90	90.5	170						140	M10	4	11				
JTW 100	100.5	190													
JTW 120	120.5	200	175	M10	4	11									

JTWP 滑块 Wear Plate

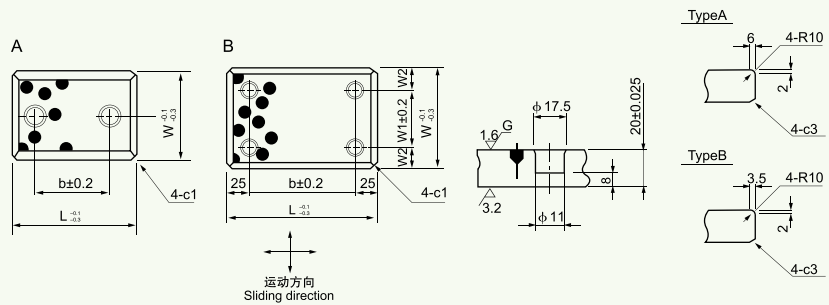

※标准产品标注方式：Standard Bushing Label Mode JTWP □ 2875

单位Unit: mm

型号规格 Designation	W _{-0.10 -0.30}	L _{-0.10 -0.30}	W1	W2	b	类型 Type
JTWP 2875	28	75	-	-	45	A
JTWP 28100		100				
JTWP 28150		150				
JTWP 3875	38	75	-	-	45	
JTWP 38100		100				
JTWP 38150		150				
JTWP 4875	48	75	-	-	45	
JTWP 48100		100				
JTWP 48150		150				
JTWP 48200		200				
JTWP 5875	58	75	-	-	45	
JTWP 58100		100				
JTWP 58150		150				
JTWP 7575	75	75	-	-	25	
JTWP 75100		100				
JTWP 75125		125				
JTWP 75150		150				
JTWP 75200		200				
JTWP 100100		100			100	50
JTWP 100125	125					
JTWP 100150	150					
JTWP 100200	200					
JTWP 125125	125	125	50	37.5	75	B
JTWP 125150		150				
JTWP 125200		200				
JTWP 150150	150	150	100	25	100	
JTWP 150200		200				
JTWP 150250		250				
JTWP 200200	200	200	150	25	150	
JTWP 200250		250				